

AFRICAN WILDLIFE

Here's what we used...

SCENEARAMA® Items

- Water Diorama Kit
- Scene Setters: African Wildlife
- Large Project Base & Backdrop

Household Items

- Craft Paints and Brushes
- Cutting Surface
- Disposable Cups
- Hammer
- Hobby Knife
- Masking Tape
- Pan for Water
- Pencil
- Plastic Bag
- Ruler
- Scissors
- Sponge
- Tree-like Stick
- Twigs

Did you know?

Africa is home to vast amounts of diverse wildlife. People from all over the world travel to Africa to go on safari and view amazing creatures. Sadly, many African animals are listed as "endangered." Endangered animals are those that scientists feel are in imminent danger of becoming extinct.

Fun Fact!

A giraffe's tail is as long as its neck! In fact, it is longer if you add in the tassel of hair at the end.

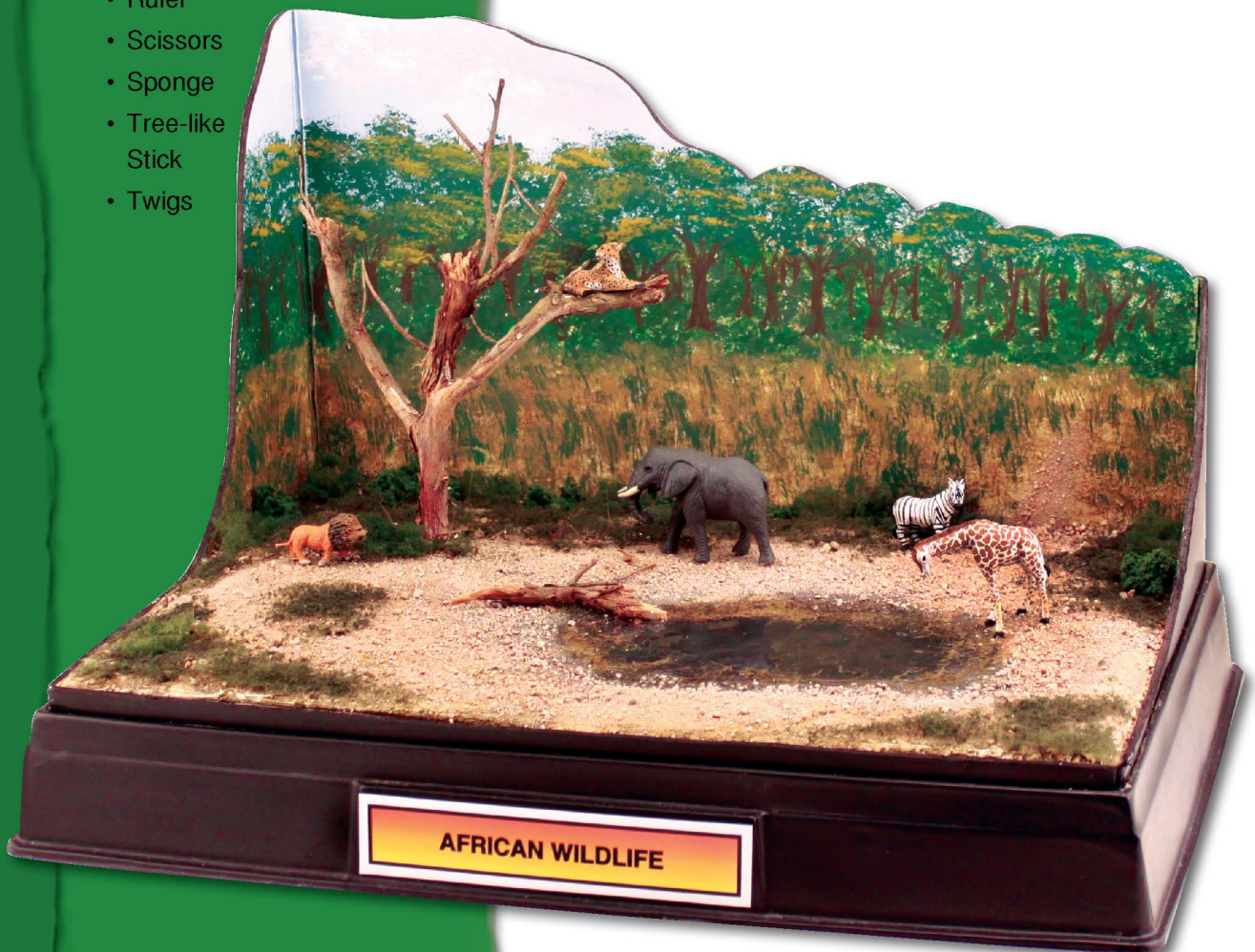
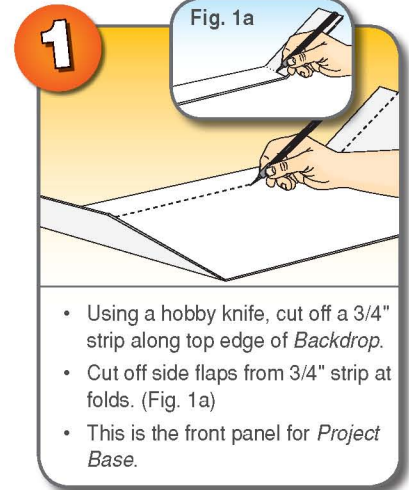

2



Fig. 2a

Project Base & Backdrop

- Design a *Backdrop* that best fits your diorama.
- Make sure front strip and side flaps on *Backdrop* are level where they meet. (Fig. 2a)
- Test fit *Backdrop* and 3/4" front strip in grooves on *Project Base*.

3

Fig. 3a

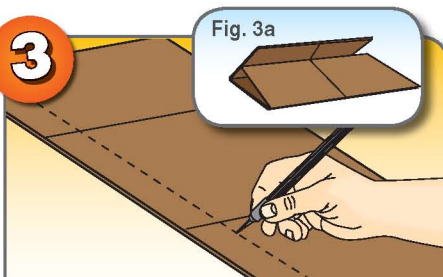

- Cut a 1" strip (lengthwise) off one edge of a *Side Panel*.
- Refold the *Side Panel*.
- Place both *Side Panels* side-by-side. Make sure the tri-folded edges are flush together and facing the same direction. (Fig. 3a)

4

Fig. 4a

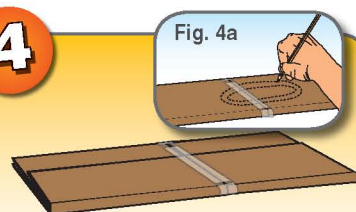

- Place masking tape around entire center seam of the *Side Panels* to attach them together and provide support.
- With the smooth side facing up, mark a bowl-shaped water area by drawing two irregularly shaped ovals, one inside the other. (Fig. 4a)

5

Fig. 5a

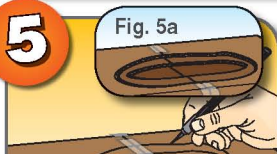

- Using a hobby knife, cut out larger oval from top layer of cardboard.
- Next, cut the smaller oval from middle layer, using cut out oval as a size guide.
- Bottom layer of cardboard should remain intact. (Fig. 5a)

6



- Test fit on *Project Base* with *Backdrop* in grooves.
- *Side Panels* should be approximately 1/8" smaller than *Project Base*.
- Remove *Side Panels* and set *Project Base* aside.

7



Plaster Cloth

- Cover entire top of *Side Panels* with wet *Plaster Cloth* (3" strips), bumpy side up.
- Smooth *Plaster* bumps with wet fingers to fill holes in *Cloth*. Holes will let *Realistic Water* leak to cardboard (Step 15).
- While damp, test fit on *Project Base* with *Backdrop* in grooves.
- Overlap edges by 1/2".

8



Earth Undercoat

- On dry *Plaster Cloth*, dab and brush diluted *Earth Undercoat* until covered.
- NOTE:** Save some diluted *Earth Undercoat* for Step 10.

9



Paint Water Areas

- Paint center of water area with *Water Undercoat*.
- Dip *Foam Brush* in water and dab wet paint out to edges.

TIP! Darker paint in center of water area gives illusion of depth.

10

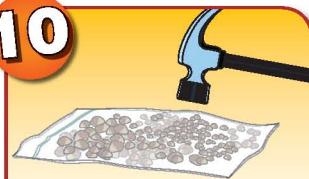

Talus

- Crush *Talus*. A mixture of sand and larger *Talus* pieces gives the best effect.
- Pour crushed *Talus* into remaining *Earth Undercoat* and stir to mix.
- Remove *Talus*, and let dry on newspaper.

11

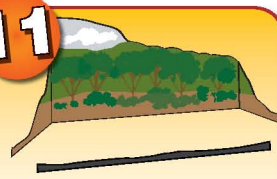

Paint

- Use craft paints to paint *Backdrop* (front and back).
- Incorporate details such as a path, grasslands, trees, sky, etc.

TIP! We used a small piece of household sponge to paint trees.

12



- Using *Project Glue*, attach *Backdrop* and front strip to *Project Base*.

- Make sure the label area faces forward.
- Attach diorama to *Project Base* with *Project Glue*.

13



Project Glue in Spray Bottle

- Spray diluted *Project Glue* on *Earth Undercoat*.
- Sprinkle *Talus* on desired areas.
- Spray again to seal.

NOTE: Avoid water area.

14

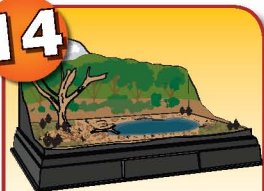

Ground Cover

- Add *Foliage Fiber*.
- Add *Shrubs*.
- Add twigs for fallen branches.
- Add a tree-like twig for a tree.

15



Realistic Water

- Pour half of the *Realistic Water* slowly in center of water area.
- Pull out to edges with *Stir Stick*. Let dry until clear.
- Then, pour remaining *Realistic Water*.

16

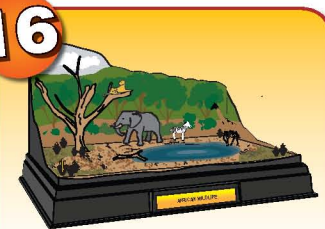

Labels

- Use *Project Glue* to attach *Scene Setters* in desired areas.
- Label and add signage to your project.