

# ICEBERGS

Here's what we used...

## SCENEARAMA® Items

- Winter Effects
- Ripplin' Water Kit
- Plaster Cloth
- Project Glue
- Small Project Base & Backdrop

## Household Items

- Corrugated Cardboard, 10" x 12"
- Craft Paints & Brushes
- Craft Wire
- Cutting Surface
- Disposable Cups
- Hobby Knife
- Masking Tape
- Miniature Whale
- Newspaper
- Pan for Water
- Pencil
- Scissors

## Did you know?

Icebergs are large floating chunks of fresh-water ice that break off from land-based glaciers and float out to sea. Some icebergs are over one hundred feet high. They are able to float because the density of the ice at their core is lighter than the ocean water that surrounds them.

## Fun Fact!

You may be surprised to learn that approximately one-eighth of an iceberg is above the waterline. Most of its mass sits in the seawater.



Usually 1/8th of an iceberg is above the waterline. That part consists of snow, which is not very compact. The ice in the core is very compact (and thus relatively heavy) and keeps 7/8ths of the iceberg under water. An iceberg that has tumbled several times has lost its light snow layers, leaving only 1/10th above the waterline.

ICEBERGS

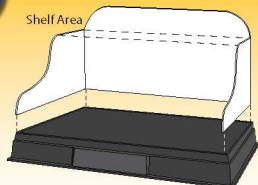
**1**

- Design a *Backdrop* using *Backdrop* material.
- Include a level shelf area for waterline.
- Cut out using a hobby knife.
- Test fit *Backdrop* in grooves on *Project Base*.

**2**

Fig. 2a

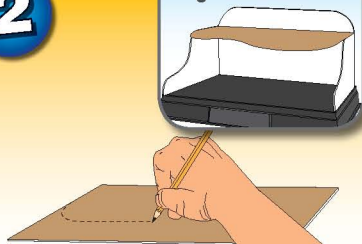

- Draw waterline pattern on cardboard.
- Cut out using a hobby knife.
- Test fit on *Backdrop*. (Fig. 2a)

**3**

Fig. 3a

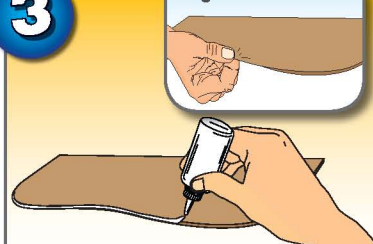

- Apply a continuous bead of *Project Glue* along front edge of waterline.
- Smooth glue into edge and pinch to create a smooth, flat surface. (Fig. 3a)

**4****Paint**

- Paint waterline with *Water Undercoat*.
  - Paint *Backdrop* as desired.
- TIP!** For an illusion of depth, paint the *Backdrop* black below the waterline.

**5**

Fig. 5a

**Newspaper Wads**

- Arrange newspaper wads into 2-part iceberg shapes (Part 1: above waterline, Part 2: below waterline).
- Use masking tape to hold shape.
- Form a flat area for attaching to waterline.

**NOTE:** Test fit Icebergs between waterline and *Project Base*. (Fig. 5a)

**6**

Fig. 6a

**Plaster Cloth**

- Cover newspaper wads with wet *Plaster Cloth* (3" strips), bumpy side up.
- Add 2 layers of *Plaster Cloth*.
- Pinch wet *Plaster Cloth* to create texture on iceberg surface. (Fig. 6a)
- Let dry.

**7****Snow Mixture**

- Paint icebergs with craft paints.
- Mix *Snow Base* and *Snowflakes* in a disposable cup.
- Dab snow mixture on top of icebergs.
- Using *Plastic Cup and Sifter Lid*, sprinkle additional *Snowflakes* while wet. Let dry.

**8****Shiny Areas**

- Brush *Realistic Water* over the iceberg sections that set below the waterline.

**9****Contact Gluing Method**

- Use *Project Glue* to attach iceberg sections to waterline.
- Let dry.

**10**

- Use *Project Glue* to attach *Backdrop* to *Project Base* (label area facing forward).
- Glue waterline with icebergs to *Backdrop*.
- Let dry.

**11****Water Effects**

- Dab *Water Effects* on top of dried *Realistic Water* using the *Stir Stick*. Let dry until clear (approx. 24 hours).

**12**

- Add a whale to define the scale of the icebergs.
- Display whale on a piece of craft wire or glue to *Project Base*.

**13****Labels**

- Label and add signage to your project.